

# Structural Performance Data

Signature 1-3/4" Outswing French Door (8610)

**WEATHER SHIELD.**  
WINDOWS & DOORS

Unit Style	Model Number	Size Tested (total frame size)	NAFS 101/I.S.2/A440 Performance Rating	Design Pressure Rating (psf)	Structural Test Pressure (psf)	Water Performance (psf)	Air Infiltration (cfm/ft <sup>2</sup> )	Forced Entry Resistance	Data Valid Until
French Outswing Door - 2 Panel Standard Sill <sup>1</sup>	8610	73.75" x 99"	LC-PG45-SHD	+/-45	+/-67.5	6.75	0.04	Grade 10	2/6/2033
French Outswing Door - 2 Panel Low profile Sill <sup>1</sup>	8610	73.75" x 98.50"	LC-PG45-SHD	+/-45	+/-67.5	6.75	0.04	Grade 10	2/6/2033
French Outswing Door Sidelite - Standard Sill	8610	37.44"x99.09"	LC-PG60-FD	+/-60	+/-90	9.00	0.02	Grade 10	8/22/2033
French Outswing Door - 2 Panel Standard Sill <sup>2</sup>	8610	73.69"x86.03"	LC-PG50-SHD	+/-50	+/-75	7.50	0.22	Grade 10	8/29/2033
French Outswing Door - 1 Panel Standard Sill <sup>4</sup>	8610	37.56"x99.09"	LC-PG40-SHD	+/-40	+/-60	6.00	0.04	Grade 10	8/23/2033
French Outswing Door - 2 Panel Standard Sill <sup>3</sup>	8610	73.69"x83.03"	LC-PG30-SHDLW	+/-30	+/-45	2.92	0.15	Grade 10	8/23/2033

Revised 5/3/24

<sup>1</sup>Units tested with Ashland 3-point lock, 2-point handle activated flush bolts, adjustable hinges.

<sup>2</sup>Units tested with Ashland 3-point lock, manual flush bolts, butt hinges.

<sup>3</sup>Units tested with Rockwell single-point lock, Ashland manual flush bolts, butt hinges.

<sup>4</sup>Units tested with Ashland single-point lock, adjustable hinges.

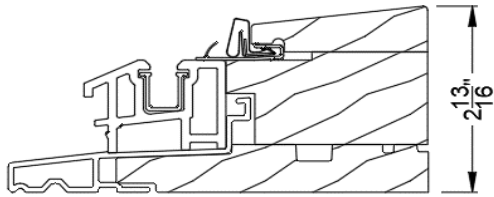

Standard Sill

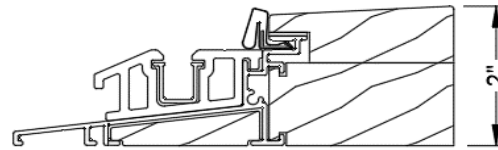

Low Profile Sill